



PREFERRED CAPITAL
MANAGEMENT INCORPORATED

Potential Development Site



3+ Acres
Enumclaw, WA

Zoned Multi-Family

Planned WSHFC
Application 2012
Parcel ID: 1920079136

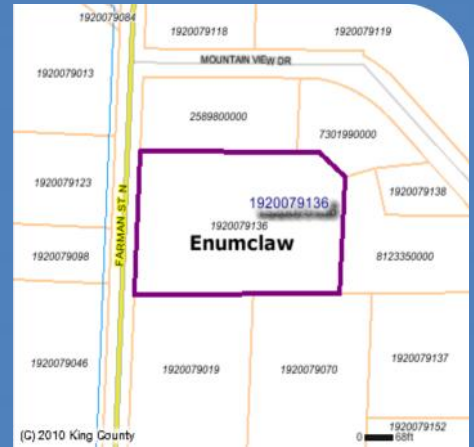

(C) 2010 King County

Site is located at the base of Mount Rainier in beautiful Enumclaw, WA. Located near a local golf course, Expo Center, and other retirement communities, makes this site a prime development opportunity for a Senior Tax



For More Information:

Darrel Dickson
President & Broker
ddickson@pcmigroup.com
p. 360.802.0817
f. 360.802.0688